

ADDENDUM NO. 2

PUBLIC STAIRWAY **CONSTRUCTION PHASE**

BID #26-011
PAWTUCKET, RI

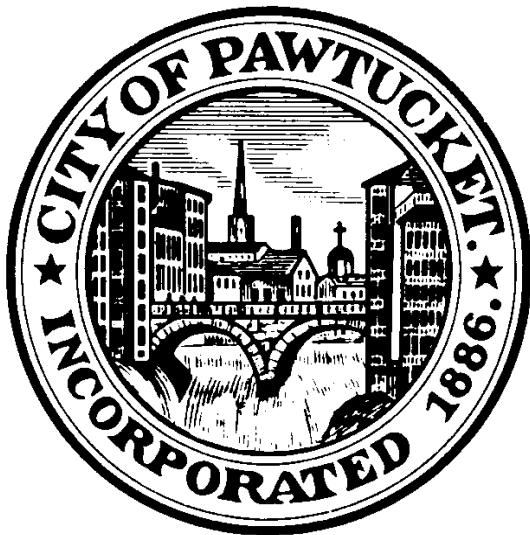

PAWTUCKET, RHODE ISLAND

DEPARTMENT OF PUBLIC WORKS
250 ARMISTICE BOULEVARD
PAWTUCKET, RHODE ISLAND

ISSUED: June 18, 2026

Addendum #2 –June 18, 2026

PUBLIC STAIRWAY CONSTRUCTION PHASE BID #26-011 Pawtucket, RI

The attention of bidders submitting proposals for the above-referenced project is called to the following Addendum to the Request for Proposals indicated above. The items set forth herein, whether of omission, addition, substitution or other change, are all to be included in, and form a part of the proposed Contract Documents for the work.

Inclusion of this Addendum must be acknowledged in the spaces provided in the document entitled “Request for Proposals Bid #26-011; Public Stairway Construction Phase”. Failure to acknowledge any and all addenda in the above specified bid form may be cause for rejection of the bids by the Owner on the grounds that it is not responsive.

This Addendum consists of two (2) pages and one (1) attachment, (4 pages), for a total of 6 pages.

1. UPDATES TO REQUEST FOR PROPOSALS

- Section 11.0 – Bid Form
 - Section 11 Page 5 of 17, Part A – Offer paragraph A.

Add the following text to end of paragraph:

The Price shall include all labor, overhead and profit.

- Section 11 Page 6 of 17

Delete the last paragraph Substitution Request Language in its entirety.

~~Substitution Request Language:~~

~~The bidder shall identify and document cost implications involved in all substitution requests.~~

~~Any and all cost savings shall be returned to the Contract.~~

- Appendix G – Technical Specifications
 - Specification 01025 Measurement and Payment page 6, Bid Item No. 4, Paragraph B, No. 3.

Delete the words – ~~and controlled blasting~~

- Specification 01025 Measurement and Payment page 11, Bid Item No. 15, Paragraph B,

Add the following paragraph text:

No. 3 This item shall include full compensation for all labor, equipment, materials, and incidentals necessary to completely install temporary and permanent bituminous concrete pavement trench patches. The removal and disposal of any temporary trench pavement shall be considered incidental to the work and not be measured separately for payment.

2. Plan Clarifications

- a. Electrical Junction Boxes JB1-JB7 locations shall be fully coordinated and may be affixed to the steel framing below the metal landing grating. Refer to Structural Drawings for landing cross sections. Handholes for Light Types EB and EC are required.

3. Questions

- a. What is the required concrete mix specification for the stairs, walls, footings, landing, light foundations, columns, and caps?

Response:

Refer to Specification 03300 Cast In Place Concrete
Section 2.2 CONCRETE STRENGTHS AND PROPORTIONS
Paragraph B. The exact proportions for the mix, including amounts admixture (if any), and water, shall be determined by the concrete supplier.

From Plan Sheet S-1

The stairs, walls, footings, landings, columns and caps shall be 5,000 P.S.I. (Normal Weight) with Max. Water Cement Ratio of 0.40.

Additional Clarification:

Only footings and housekeeping concrete shall have a max water cement ration of 0.40.
Abutments, walls, column stems/caps, and slab-on-grade shall have a max water cement ration of 0.45.

From Plan Sheet 29

Refer to re-issued sheet 29 included in Addendum No 2.

- b. Can you confirm that an initial trench patch will be sufficient repair for the runs of conduit in the parking lot area that does not receive full depth replacement?

Response: A full depth trench patch will be required for the area outside of the full depth replacement within the parking lot. A detail has been provided with this Addendum.

ATTACHMENTS:

- A. Supplemental Details and Plans
 - a. Conduit Trench Patch
 - b. RI Standard Detail 18.1.0
 - c. Sheet 29

Please contact Michael Wilcox (401-728-0500 ext. 447), City of Pawtucket, with any questions.

Attachment A: Supplemental Details and Plans

\\BETA-INC.COM\IT\TRANS\1400\1433 - TIDEWATER PHASE 1\AUTOCAD FILES\3 STAIRS\CONSTRUCTION\CONDUIT TRENCH PATCH.DWG

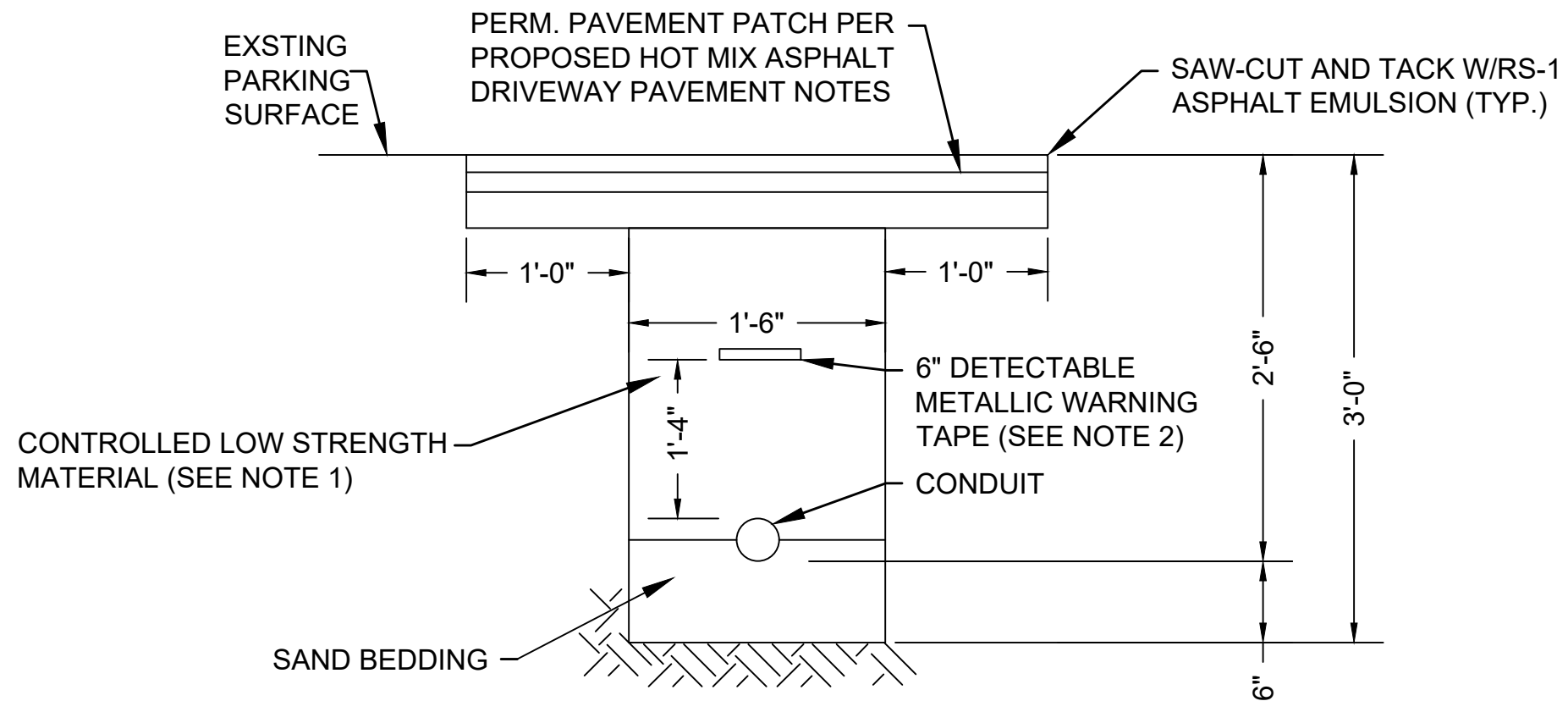

CONDUIT TRENCH PATCH

NOT TO SCALE

NOTES

1. CONTROLLED LOW STRENGTH MATERIAL SHALL MEET THE REQUIREMENTS OF RHODE ISLAND DEPARTMENT OF TRANSPORTATION STANDARD SPECIFICATIONS SECTION 603.
2. WARNING TAPE SHALL BE PER CURRENT APWA STANDARDS.

ADDENDUM NO. 2



**Pleasant Street Public Stairway
Construction Phase**

Pawtucket, RI
Plot Date: 6/16/2026 11:28 AM

TRENCH PATCH DETAIL

ADDENDUM NO. 2

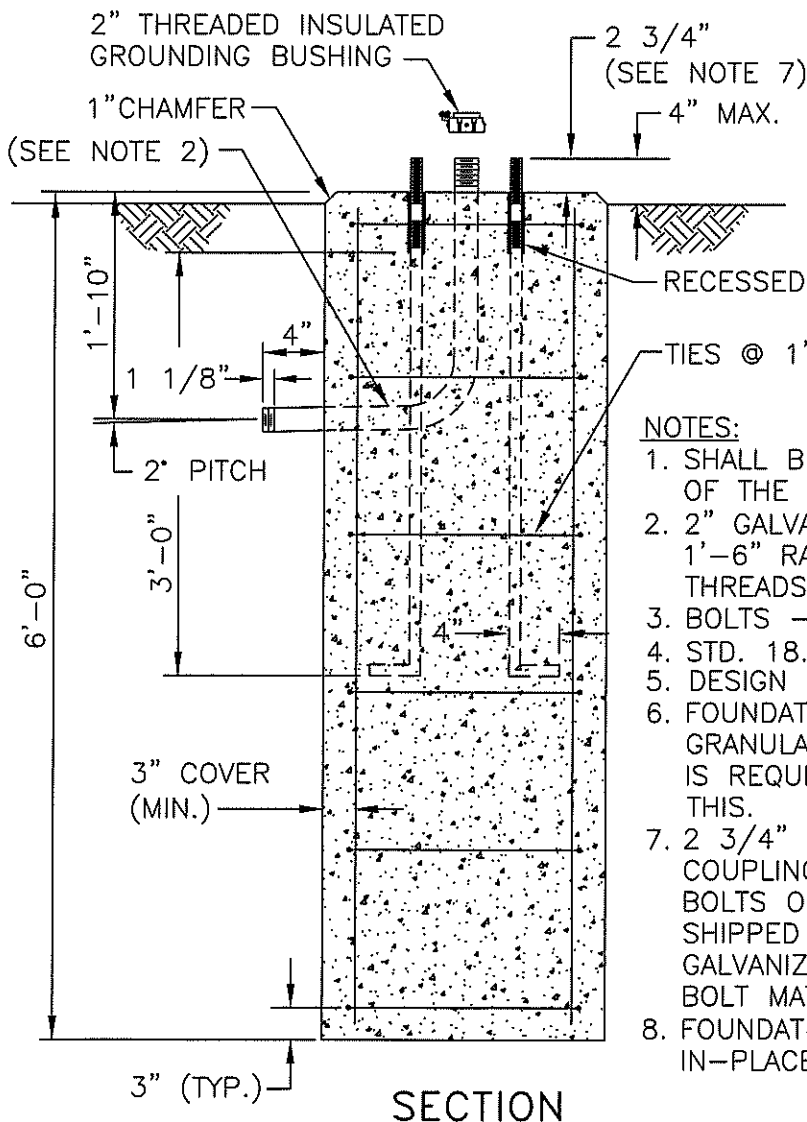
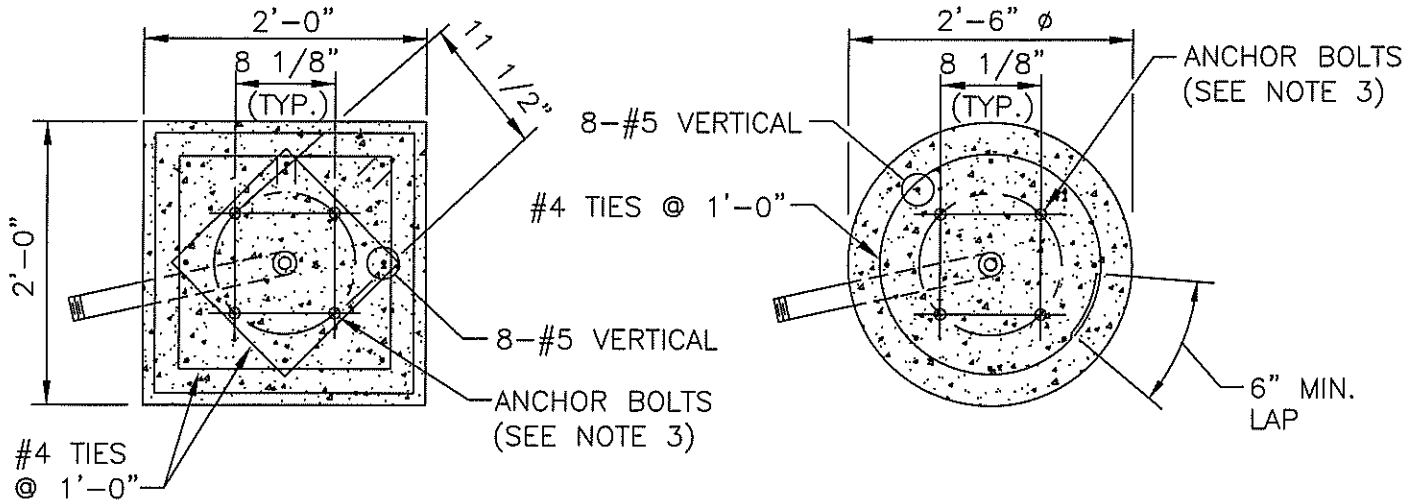

CONCRETE TOLERANCES	
DIMENSION	TOLERANCE
0"-12"	1/4"
12"-24"	1/2"
24"-72"	3/4"

NOTES:

1. SHALL BE IN ACCORDANCE WITH SECTION T.08 OF THE R.I. STANDARD SPECIFICATIONS.
2. 2" GALVANIZED CONDUIT WITH 92° BEND AND 1'-6" RADIUS, PROJECTING 2 3/4" AS SHOWN. THREADS TO HAVE PROTECTOR.
3. BOLTS - (4) 1" ϕ x 3'-0" LONG WITH 4" HOOK.
4. STD. 18.3.5 TO BE USED WITH THIS STANDARD.
5. DESIGN BOLT TENSION = 30 K.
6. FOUNDATION DESIGN IS BASED ON COMPETENT GRANULAR SOIL CONDITIONS. A SPECIAL DESIGN IS REQUIRED IF FIELD CONDITIONS VARY FROM THIS.
7. 2 3/4" PROJECTION OF RECESSED BOLT COUPLINGS (RI STD. 18.3.5). ALL GALVANIZED BOLTS ON A 11 1/2" BOLT CIRCLE SHALL BE SHIPPED WITH GALVANIZED WASHERS AND GALVANIZED HEX NUTS (BOLT THREAD IS 8NC). BOLT MATERIAL IS 55,000 PSI MIN. YIELD.
8. FOUNDATIONS MAY BE PRECAST OR CAST IN-PLACE.

RHODE ISLAND DEPARTMENT OF TRANSPORTATION

CONCRETE LIGHT STANDARD BASE

REVISIONS		
NO.	BY	DATE
1	MLP	6/27/08

James H. Casaldi
CHIEF ENGINEER
TRANSPORTATION

Edmund J. Parker Jr.
CHIEF DESIGN ENGINEER
TRANSPORTATION

JUNE 15, 1998
ISSUE DATE



